

## V-2NF TYPE

SIZE: 1/4" ~ 2"



### Female x Male Screwed End STAINLESS STEEL

**AISI-316** (EN10213-4 1.4408) (ASTM-A351-CF8M)

**AISI-304** (EN10213-4 1.4308) (ASTM-A351-CF8)

### CARBON STEEL

**S-20C** (EN10213-2 1.0619) (ASTM-A216-WCB)

#### FEATURES:

\*Pipe thread in accordance with ANSI B2.1, BS 21 1973, DIN 259/2999, ISO 228

\*With mounting pad

\*Blow-out proof stem/Full port

\*Investment casting body and cap

\*1000 PSI (69BAR) W.O.G/2000 PSI (138BAR)W.O.G.

\*Locking device, lug body

**OPTION: Locking device**

**Drilling and Tapped Mounting Pad**

ITEM	PARTS	Q.TY	MATERIALS	
1	BODY	1	ASTM-A351-CF8M	ASTM-A216-WCB
2	CAP	1	ASTM-A351-CF8M	ASTM-A216-WCB
3	BALL	1	ASTM-A351-CF8M	ASTM-A351-CF8
4	BALL SEAT	2	PTFE	PTFE
5	JOINT GASKET	1	PTFE	PTFE
6	STEM	1	AISI 316	AISI 304
7	THRUST WASHER	1	PTFE	PTFE
8	STEM PACKING	2	PTFE	PTFE
9	GLAND NUT	1	AISI 304	AISI 304
10	HANDLE	1	AISI 304	AISI 304
11	SPRING WASHER	1	AISI 304	AISI 304
12	STEM NUT	1	AISI 304	AISI 304
13	PLASTIC COVER	1	PLASTIC	PLASTIC
14	LOCK DEVICE	1	AISI 304	AISI 304

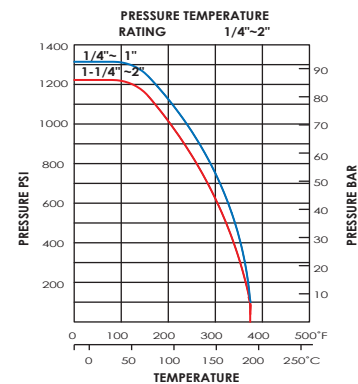
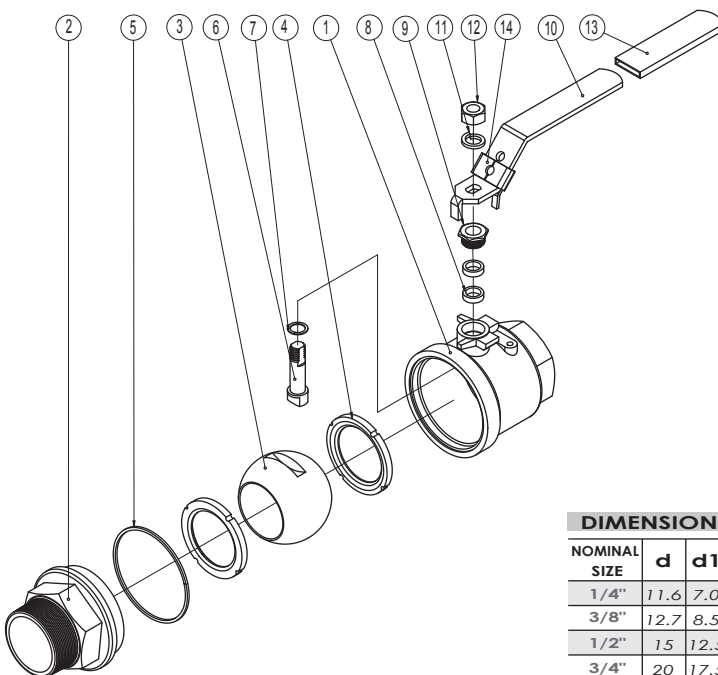
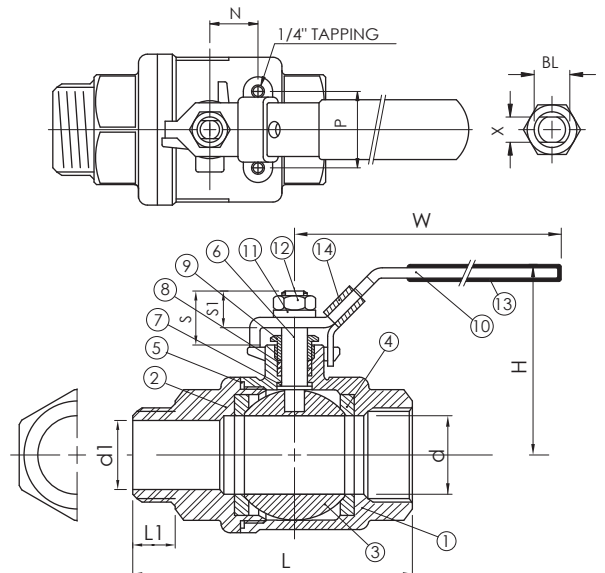

NOMINAL SIZE	DIMENSIONS											UNIT:mm		
	d	d1	L	L1	H	W	S	S1	X	N	P	BL	Cv FACTOR	TORQUE kgf-cm
1/4"	11.6	7.0	63	12.6	51	95	16.5	10.2	5.0	12.5	28.5	5/16"	6.6	40
3/8"	12.7	8.5	63.5	13.2	51	95	16.5	10.2	5.0	12.5	28.5	5/16"	7.9	40
1/2"	15	12.5	74	16.7	53	95	16.5	10.2	5.0	12.5	28.5	5/16"	11.2	54
3/4"	20	17.5	82	18.2	59	110	20	13.5	6.5	21	34.8	3/8"	21	74
1"	25	23.6	98.5	21	73	135	23.5	16	8.0	22.5	34.8	7/16"	35	104
1-1/4"	32	30.8	112.4	23.5	78	135	23.5	16	8.0	23.5	38.1	7/16"	57	135
1-1/2"	38	36.6	126.4	23.5	91	165	25.5	17	9.0	23.5	38.1	1/2"	80	180
2"	50	47.5	151.7	27.8	99	165	25.5	17	9.0	23.5	38.1	1/2"	148	250