

Specifications

Pressure Ratings

- Burst Pressures:
 - 50 to 300mm sizes 60 Bar (850 psi)
 - 350 to 600mm sizes 24 Bar (350 psi)
- Temperature Range: -10°C to 105°C
- Operating Pressures:
 - For maximum operating pressures at 80°C refer to the chart for each style.
 - For operating pressures at elevated temperatures refer to the pressure/temperature correction factors.

Vacuum Rating:

The vacuum rating for all types is 660 mm Hg. This is dependent on the joint being installed at a length between the minimum installed and the neutral length (e.g. FSF100 installed at length between 122 - 135mm).

Flange Drilling

- Standard: BS10 Table E,
- Optional: ANSI 150 lb



Pressure/Temperature Correction Factor

Operating Temp.	80°C	85°C	90°C	95°C	100°C	105°C
Maximum Working Pressure (x factor)	x 1.0	x .92	x .83	x .75	x .67	x .60

	Nominal Diameter		Installed Length mm		Travel mm	Allowable Movements from Neutral				Pressures		Use Control Unit Sets at (bar)
	inch	mm	Natural Length	Minimum Maximum Installed	Total Compressed Extended	Axial Compression	Axial Extension	Lateral Deflection	Angular Deflection	Positive Bar at 80°C	Vacuum mm	
	1-1/4"	32	95	89 - 97	87 - 99	8	4	8	15°	15.5	660	15.5
	1-1/2"	40	95	89 - 97	87 - 99	8	4	8	15°	15.5	660	15.5
	2"	50	105	99 - 107	99 - 110	8	5	8	15°	15.5	660	15.5
	2-1/2"	65	115	107 - 118	103 - 121	12	6	10	15°	15.5	660	15.5
	3"	80	130	122 - 133	118 - 133	12	6	10	15°	15.5	660	15.5
	4"	100	135	122 - 140	117 - 145	18	10	12	15°	15.5	660	15.5
	5"	125	170	156 - 175	152 - 180	18	10	12	15°	15.5	660	14.0
	6"	150	180	167 - 185	162 - 190	18	10	12	15°	15.5	660	14.0
	8"	200	205	186 - 212	180 - 220	25	14	22	15°	15.5	660	14.0
	10"	250	240	221 - 247	215 - 254	25	14	22	15°	15.5	660	10.0
	12"	300	260	241 - 267	235 - 274	25	14	22	15°	15.5	660	10.0
	14"	350	265	246 - 273	240 - 281	25	14	22	15°	10.0	660	7.0
	16"	400	265	246 - 273	240 - 281	25	14	22	15°	8.5	660	7.0
	18"	450	265	246 - 273	240 - 281	25	14	22	15°	8.5	660	7.0
	20"	500	265	246 - 273	240 - 261	25	14	22	15°	8.5	660	7.0
	24"	600	265	246 - 273	240 - 261	25	14	22	15°	8.5	660	7.0

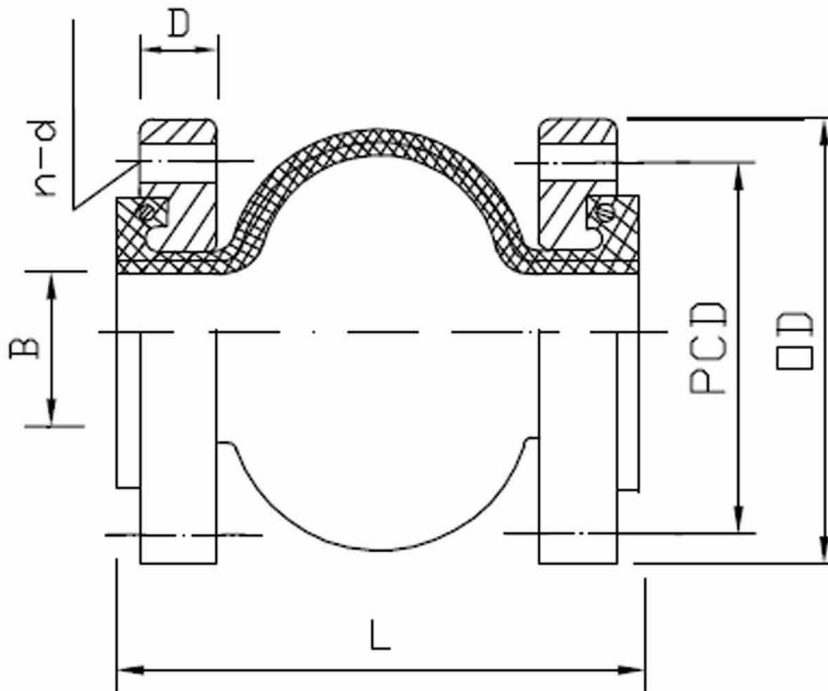

MATERIALS

EPDM (Std) 105°C
 Neoprene 60°C
 Buna-N 80°C
 Viton 150°C
 Teflon Lined 180°C

PRESSURE

16 Bar

FLANGE

Table E - standard
 ANSI 150 - indent only
 PN16 - indent only

DN	L	OD	PCD	n-d	D
40	95	133	98	4-14	15
50	105	152	114	4-17.5	15
65	115	165	127	4-17.5	15
80	135	184	146	4-17.5	18
100	135	216	178	8-17.5	18
125	160	254	210	8-17.5	20
150	185	279	235	8-22	20
200	200	337	292	8-22	20
250	240	406	356	8-22	22
300	260	457	406	12-25	25
350	260	525	470	12-26	29
400	260	580	521	12-26	32
450	270	640	584	16-26	35
500	275	705	641	16-26	35
600	275	825	756	16-33	35

RUBBER
 BELLOW