

The pneumatic Pinch Valve type VMP-Compact



 **Reliable and cost-effective!**

The compact valve solution for automatic shut off. For example dust, granule, powder, suspension, sewage, air venting etc.

Advantages:

- Extremely compact
face to face length reduced up to 30%
- Weight reduced by 25%
- Suitable for food applications
- Explosion protected design
- Excellent weather resistance
- Complete free passage
- No plugging
- 100% tight shut off
- Easy maintenance and re-sleeving

The pneumatic Pinch Valve type VMP-Compact

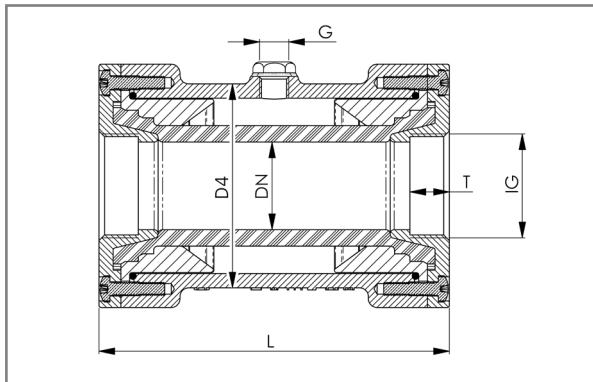
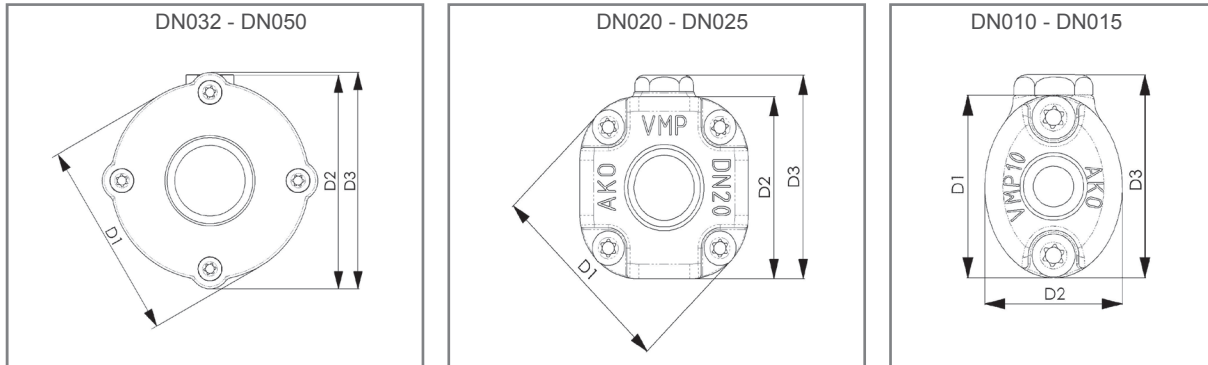

Industrial areas:

Pneumatic conveying systems / pigments and granules / ceramics/glass/plastic industry / pharmaceutical/food industry / extraction systems / dosing systems / filling and weighing systems / air venting systems

DN (mm)	Imp. (inch)	T (mm)	L (mm)	D1 (mm)	D2 (mm)	D3 (mm)	D4 (mm)	G (inch)	PS max. (bar)	Screws	volume (ml)* (ca./approx.)	weight (kg)
10	G $\frac{3}{8}$ "	12	80	45	34	50	45	1/8	6,0	4	15	0,15
15	G $\frac{1}{2}$ "	14	95	55	46	60	55	1/8	6,0	4	25	0,25
20	G $\frac{3}{4}$ "	17	103	63	56	62,5	56	1/8	6,0	8	40	0,35
25	G1"	17	120	75	70	75	70	1/8	6,0	8	80	0,50
32	G1 $\frac{1}{4}$ "	18	135	90	98	97	77	1/4	4,5	8	150	0,65
40	G1 $\frac{1}{2}$ "	18	160	103	111	110,5	93	1/4	4,5	8	300	1,00
50	G2"	24	170	120	130	129	113	1/4	4,5	12	450	1,50

Volume = Control volume with closed sleeve

Standard adaption:

Internal pipe thread (DIN ISO 228) or NPT, others on request

Materials:

Body / socket ends

POM natural white	FDA approved
POM black	excellent weather resistance
POM conductive	for ex-areas (EX)

Sleeves:

Natural rubber anti-abrasive, natural rubber food quality, EPDM, nitrile, hypalon, butyl, neoprene, others on request.